



POST PRESS  
MAILROOM  
BOOKBINDERY

RS 840 - DOUBLE STREAM TRIMMER

**RIMA  SYSTEM**

## Requirements & Solutions

The RIMA-SYSTEM RS 840 is an innovative and space saving Double Stream Rotary Knife Trimmer with electric format adjustment. With two independent and easily accessible trimming modules positioned one above the other the RS 840 may be used in-line or off-line with one stream or two streams simultaneously. Unique features like the infeed jogger with "Hexbrator Technology", "Integrated knife cooling" and "Zero-Gap Adjustment" guarantee a precise trim, a perfect run-out and maximum lifetime. Multi Knife and "Double Trim" Technology allows to choose between different sets of knives for ideal conditions in every application. The wide opening guards make the machine perfectly accessible. Highest reliability, low knife prices and inexpensive resharpening minimize the operation costs.

## Technical Data

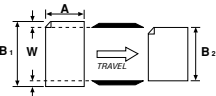
Formats		min	max
	"A"	114 mm (4.49")	530 mm (20.87")
	"B1"	98 mm (3.86") before 1-side trim 101 mm (3.98") before 2-side trim	530 mm (20.87") before 1-side trim 530 mm (20.87") before 2-side trim
Waste paper (depends on product)	"W"	3 mm (0.12")	50 mm (1.97")
Product width (after trimming)	"B2"	95 mm (3.74") after 1-side trim 95 mm (3.74") after 2-side trim	527 mm (20.75") after 1-side trim 524 mm (20.63") after 2-side trim
Product thickness	Single product Shingled stream	2 pages 8 pages (4 products)	128 pages (max. 15 mm (0.59")) 512 pages (max. 15 mm (0.59"))
Speed (per stream)	adjustable		120.000 cph (80 m/min)
Product orientation	spine leading, spine to the side (in exceptional cases: spine trailing)		
Infeed / delivery height	lower level upper level	600 mm (23.62") 1400 mm (55.12")	
Input power	400 V, 3~, N, PE, 12 kW (RS 840 - 4 knives) / 8 kW (RS 842 - 2 knives)		
Air requirement	basically no air consumption @ 6 bar (@ 87 psi)		
Suction capacity*	air quantity per connection: 900 m³/h, air speed: 31m/sec		
Options	coldset option, trimming lower knives, JDF-integration		

Technical specification available upon request. The manufacturer reserves the right to change the technical specification without prior notice. (RS 840-EN-March 2010) \* Non binding, minimum requirements

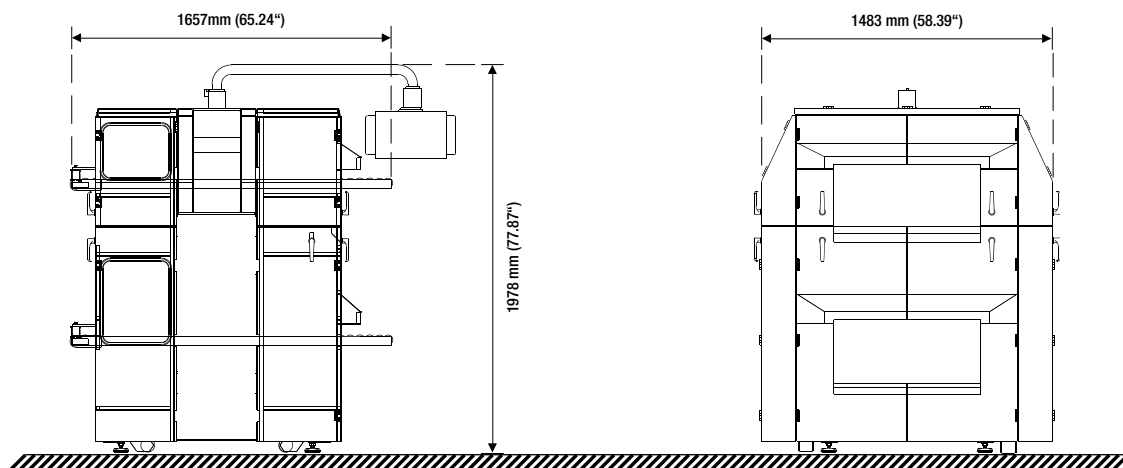

**RIMA SYSTEM**

[www.rima-system.com](http://www.rima-system.com)

RIMA-SYSTEM Europe, Germany · RIMA-SYSTEM Atlanta LLC, USA · RIMA-SYSTEM Far East Pte Ltd, Singapore · RIMA-SYSTEM Corporate Office, USA  
SYSTEM UK Ltd, United Kingdom · CIVIEMME-SYSTEM S.r.l., Italy · RIMA-SYSTEM Support Center Central America, Guatemala